

THE NEW YORKER

KERASAN

Art. 5680

Cassetta alta
High level cistern

Art. 5618

vaso btw cm 60
btw wc pan cm 60

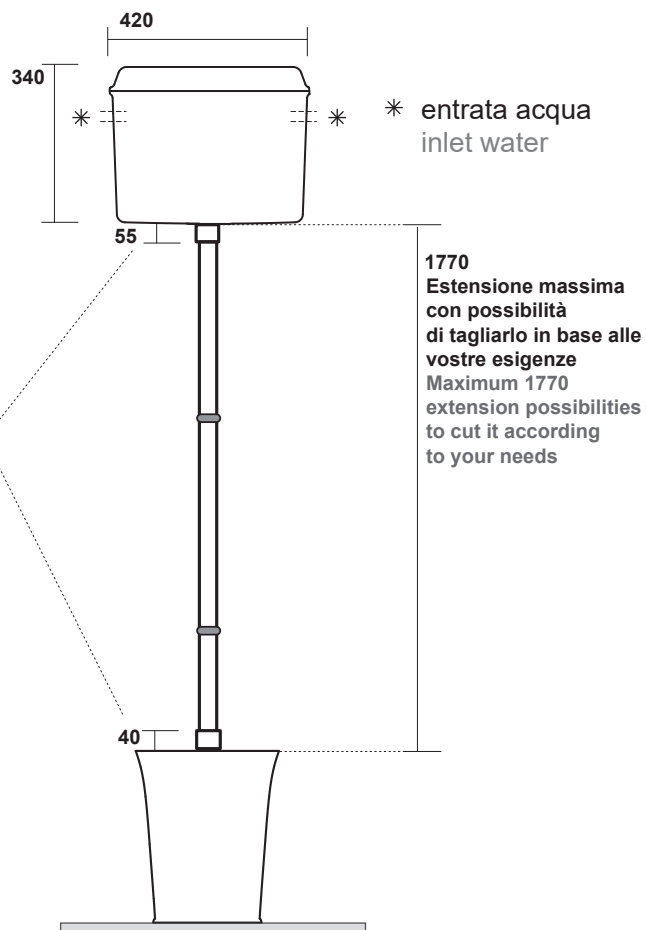
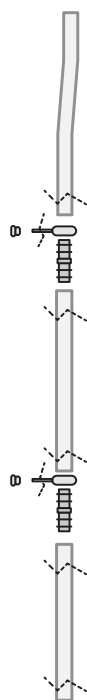
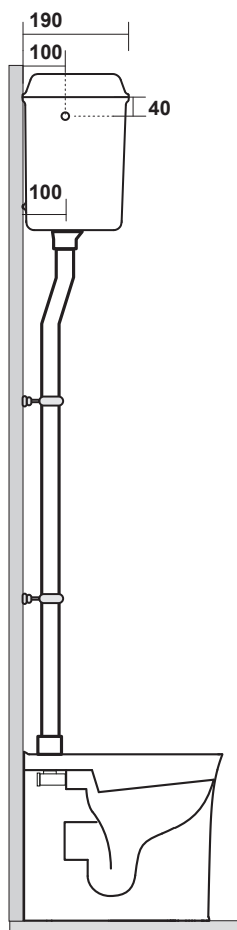

innesti tubo:
55 max in alto
40 max in basso

Part to be inserted:
upside mm 55 max
down mm 40 max

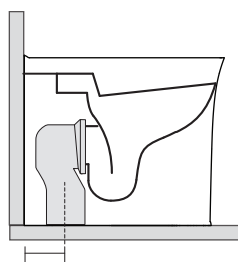
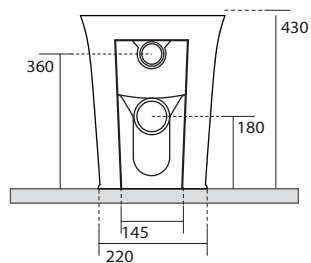
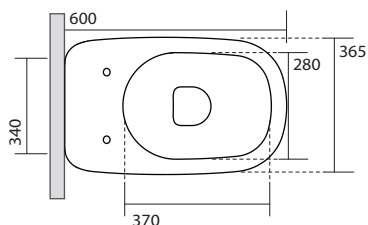

150 mm con curva
art. 900102

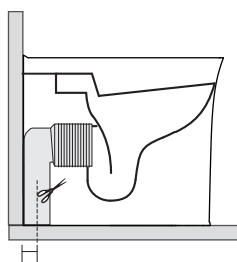

max. 140 // min. 60
con curva art. 900104

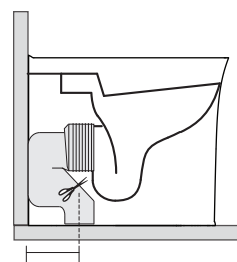

max. 230 // min. 170
con curva art. 7619

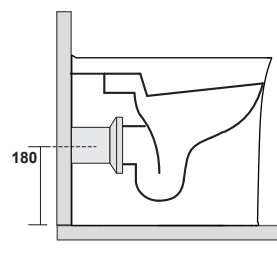

180
tubo di raccordo
a parete art. 7539

ASSEMBLY INSTRUCTIONS

1

INSTALLARE IL MECCANISMO NELLA CASSETTA IN CERAMICA.

ABBASSARE IL PERNO CON ASOLA TRAMITE GUARNIZIONE FINO A RAGGIUNGERE L'ALTEZZA CORRETTA PER L'ASTA DELLA MANIGLIAA.

Insert the flushing mechanism into the ceramic cistern.
Insert the top cap assembly into the main body of the flushing mechanism and push up the black O-ring.
Adjust the height of the fill valve until the lifting rod is horizontal.

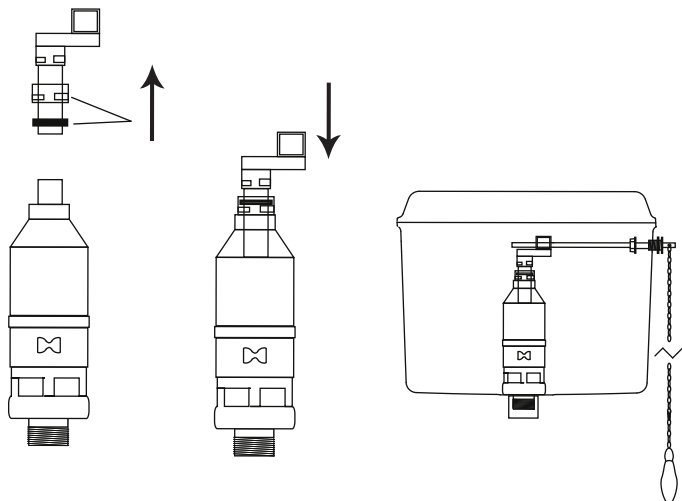

2

ASSEMBLARE IL GOMITO PER IL COLLEGAMENTO DEL TUBO AL WC COME IMMAGINE SOTTO.

PER UNA CORRETTA TENUTA AL PASSAGGIO DELL'ACQUA ASSICURARSI CHE LA GUARNIZIONE CONICA NERA SIA PERFETTAMENTE POSIZIONATA.

Insert the L-shaped flush pipe into the toilet as shown in the illustration. Insert the black connecting piece into the L-shaped flush pipe.

Make sure that conical sealing washer of the flush pipe is perfectly positioned to ensure a perfect seal.

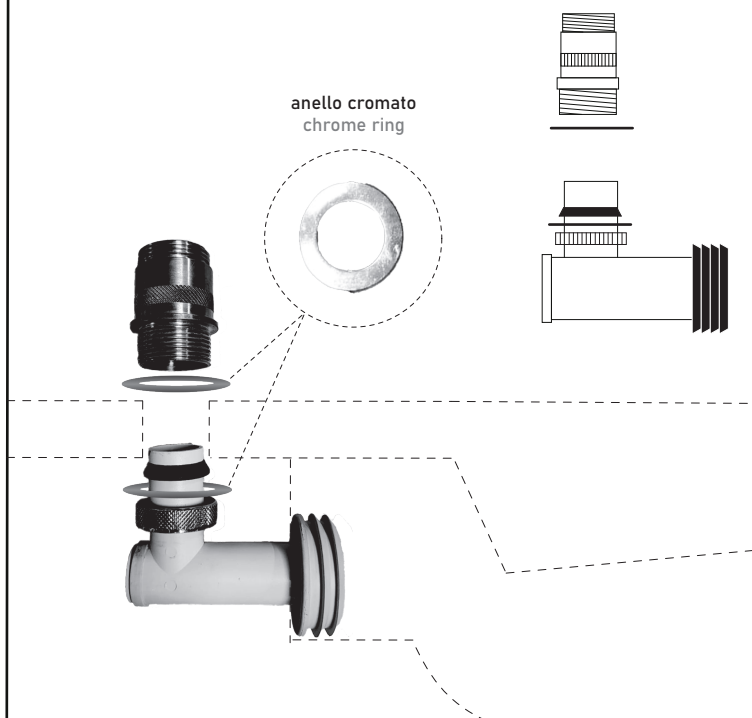

3

WC CON GOMITO INSTALLATO

The illustration shows the complete installation of the L-shaped flush pipe.

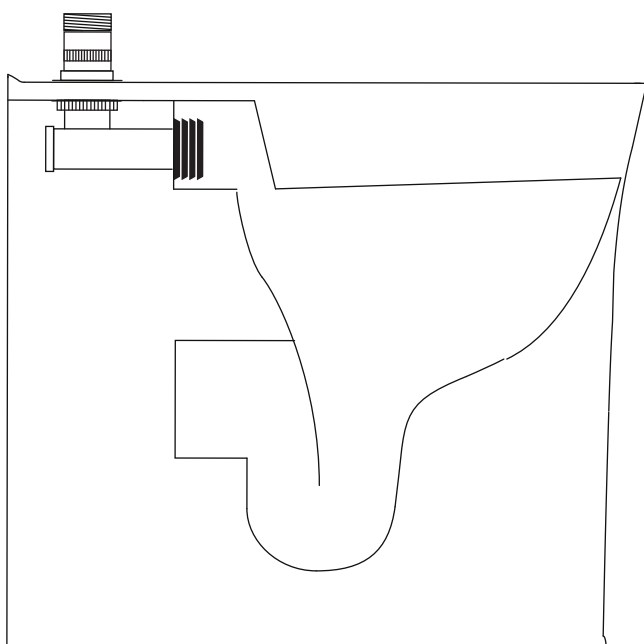

4

IMPRONTARE LA CASSETTA A MURO SENZA FISSARLA DEFINITIVAMENTE IN MODO TALE DA PRENDERE LE MISURE CORRETTE, L'APPIOMBO DEL MURO DETERMINA LA DISTANZA DEL TUBO DALLA PARETE PER TUTTO IL PERCORSO.

Temporarily mount the cistern on the wall without fixing it. Measure from the bottom of the cistern to the top of the toilet.

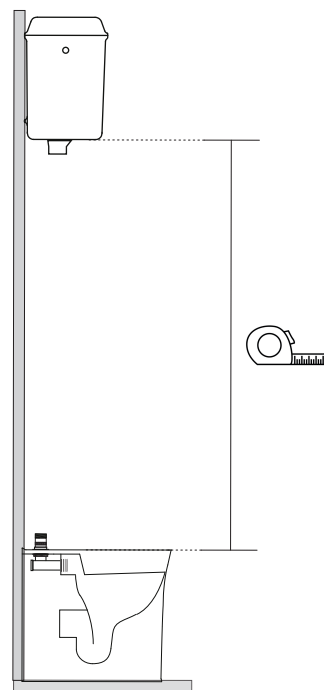

5

ASSEMBLARE IL TUBO E TAGLIARE LA PARTE INCURVATA A SECONDA DELLE PROPRIE ESIGENZE (ALTEZZA MAX 1770)

Connect the three parts of the chrome-plated flush pipe together and cut off the part that ends with a 90° bend to obtain the desired height (MAX. height 1770 mm).

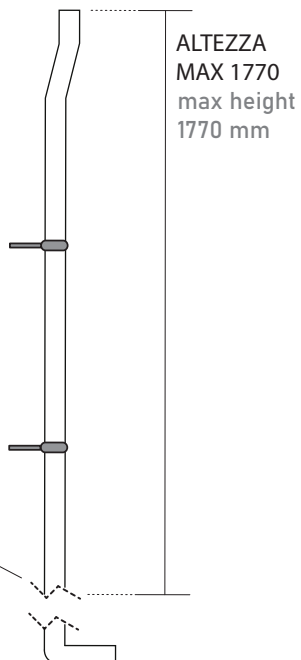

tagliare la parte curva del tubo

Cut the bend of the chrome-plated flush

6

INNESTARE IL TUBO AL GOMITO INSERENDO LA GUARNIZIONE CONICA NERA E LA RONDELLA COME FIGURA SOTTO E SERRARE IL TUTTO. PER UNA CORRETTA TENUTA AL PASSAGGIO DELL'ACQUA ASSICURARSI CHE LA GUARNIZIONE CONICA NERA SIA PERFETTAMENTE POSIZIONATA.

Insert the screw cap and the seal into the chrome-plated flush pipe. Insert the chrome-plated flush pipe into the upper end of the L-shaped flush pipe as shown below and tighten the screw cap.

Make sure that conical sealing washer of the flush pipe is perfectly positioned to ensure a perfect seal.

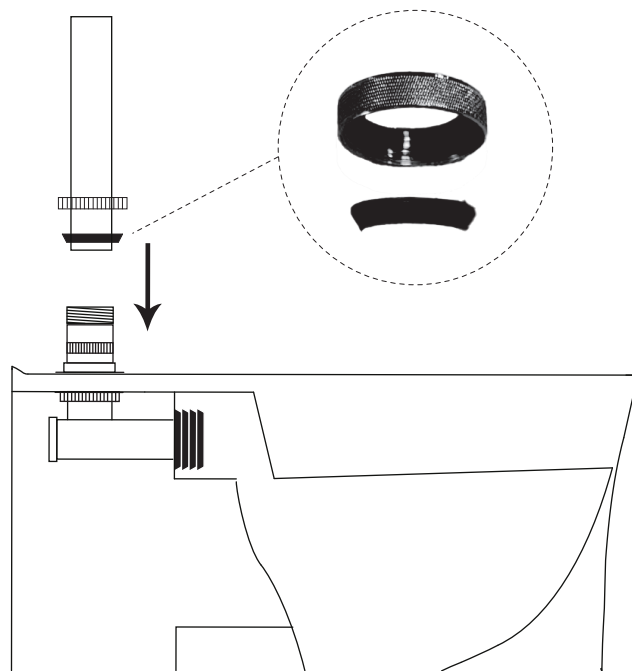

7

FISSARE IL TUBO A MURO TAGLIANDO I SUPPORTI A MISURA SECONDO LA DISTANZA RILEVATA SUL POSTO.

Attach the chrome-plated flush pipe to the wall using the wall fastening clips supplied. Cut the wall mounting clips to the correct size and make sure that the chrome-plated flush pipe is straight so that it fits into the cistern and toilet.

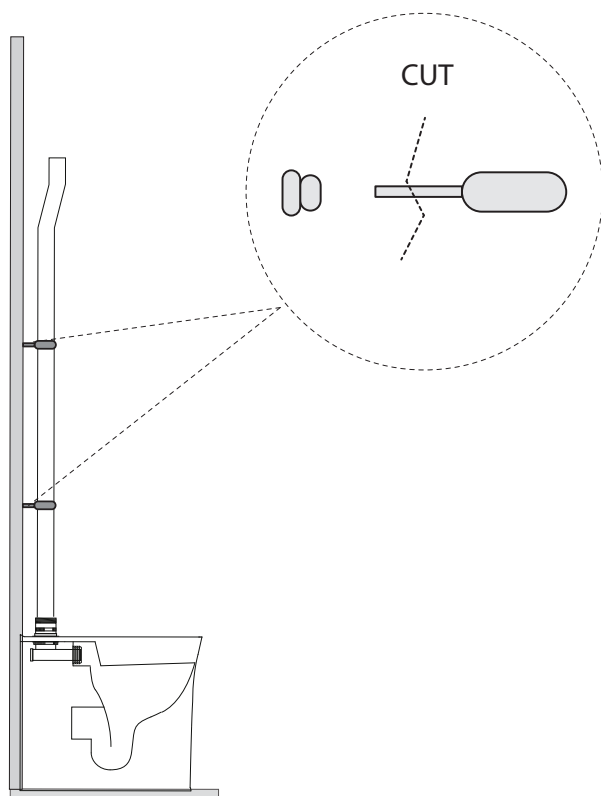

8

INSTALLARE LA CASSETTA.

Fix the cistern permanently

